

## Application

Tucson test couplings and hoses are applied for the monitoring and control of pressure as well as the ventilation.

The advantages of this system are – among other – connection at system pressure level, the easy connection to

measurement control and switching devices, and the leak proof connection of the metal cap.

The Couplings provide a Male BSP to MinimeSS Hose connection while the Gauge adapters provide a Female BSP to MinimeSS Hose connection

## Specifications

Figures based on: Oil Temp = 40°C Viscosity = 40 cSt

Max Pressure	630 bar
Port Size	1/4 BSP
Cartridge Material	Carbon Steel (Cr-VI free)
Seal Material	Nitrile Rubber (Buna N/NBR)
Sealing Type	Soft Sealing
Cap	Round metallic
Weight	0.04 Kg
Filtration Level	BS5540/4 Class I8/I3 (25µ nominal)
Operating Temp	-20°C to +200°C
Leakage	1.0 millilitres/min or better
Viscosity Range	5 to 500 cSt

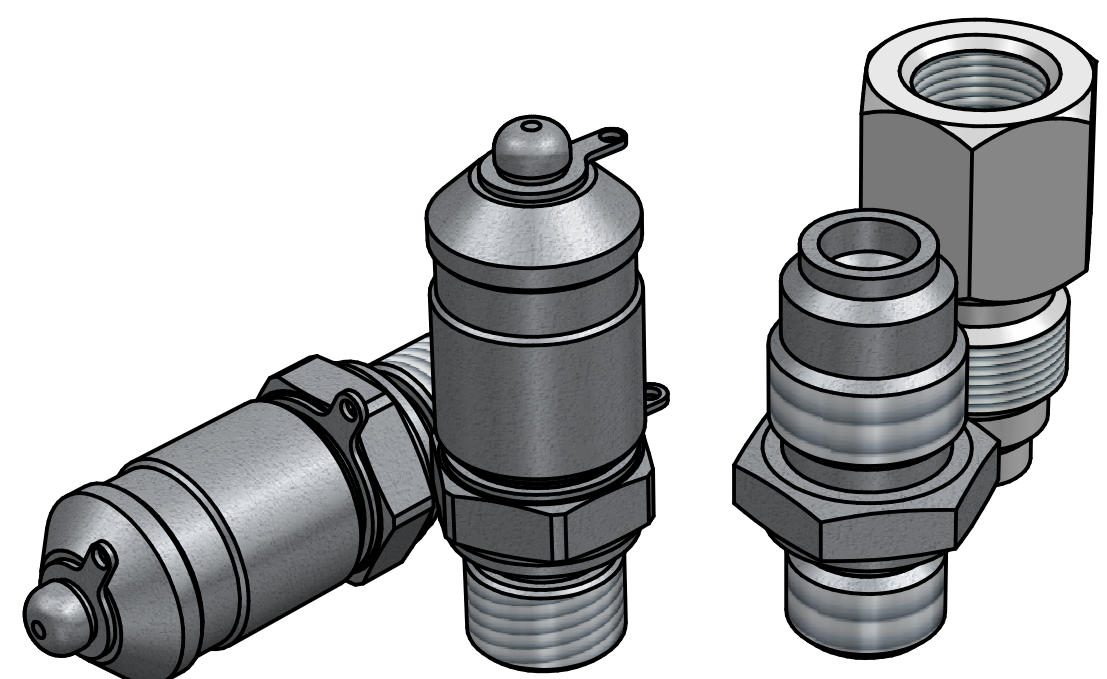

3D ISOMETRIC VIEW

Where measurements are critical request certified drawings. We reserve the right to change specifications without notice.

**COMPLETE VALVE** 1/4" BSP - M16 x 2  
BASIC CODE: 2301 01 51

**ORDER**

2103 01 51

BASIC CODE

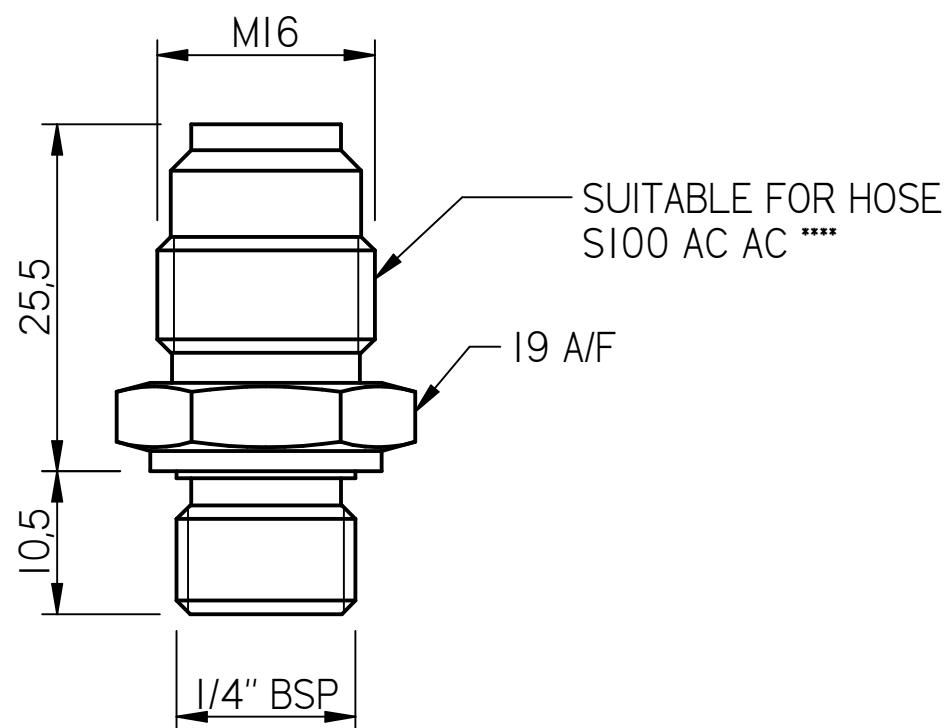

**COMPLETE VALVE** 1/4" BSP - M16 x 2  
BASIC CODE: 2301 05

**ORDER**

2301 05 0100

BASIC CODE

PORT  
0100: 1/4 BSP

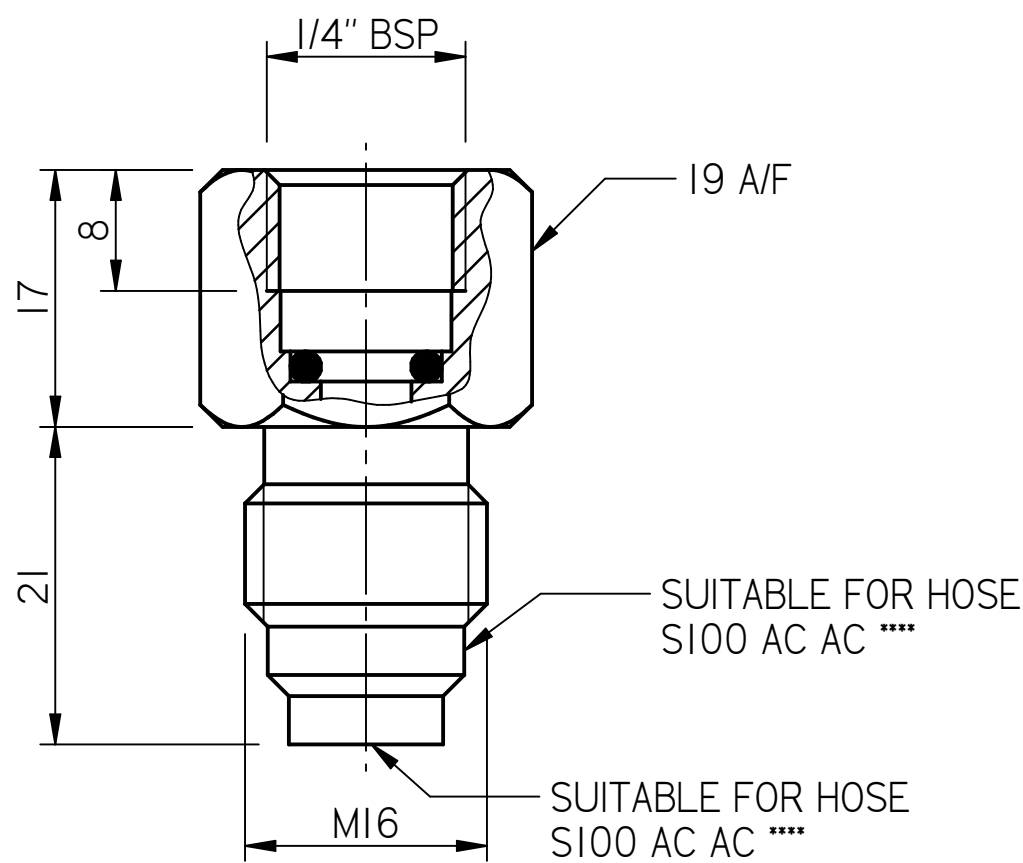

**COMPLETE VALVE** M16 x 2  
BASIC CODE: S100 AC AC

**ORDER**

S100 AC AC 1000

BASIC CODE

CONNECTION  
ACAC: ADOPTER I620  
BOTH ENDS

LENGTH  
0100: 1 m  
0200: 2 m  
0400: 4 m

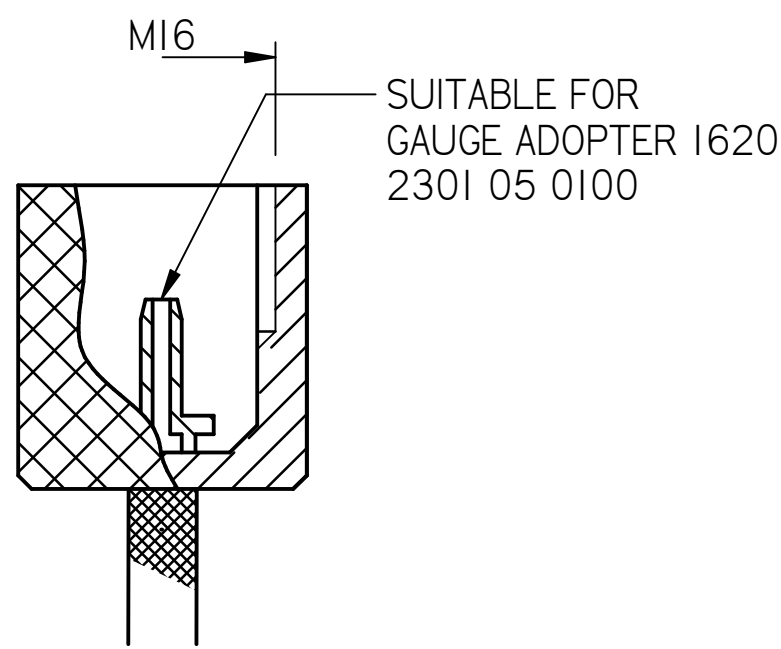

15

Where measurements are critical request certified drawings. We reserve the right to change specifications without notice.